

HOW WELL DO YOU KNOW THE ARCHITECTURE OF GREEK CITIES

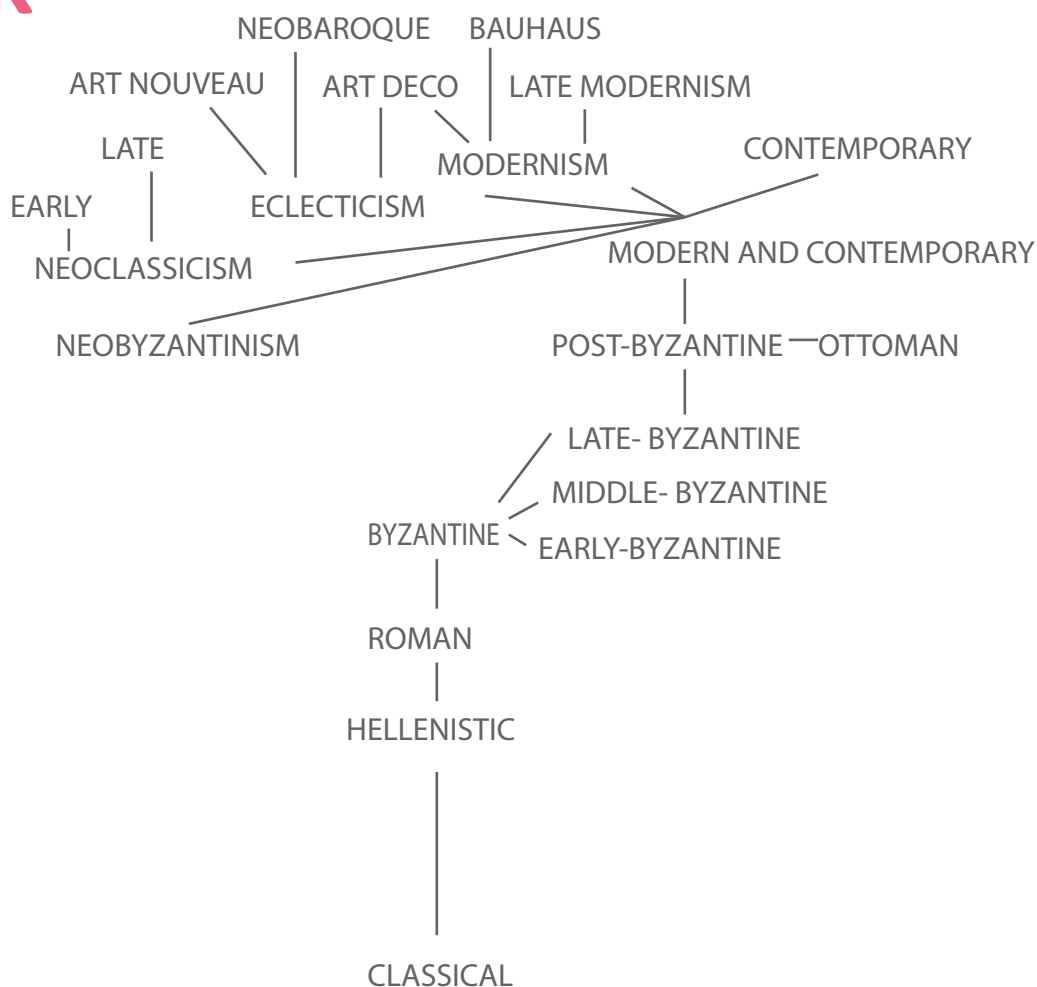

bon Flâneur
occupy the city

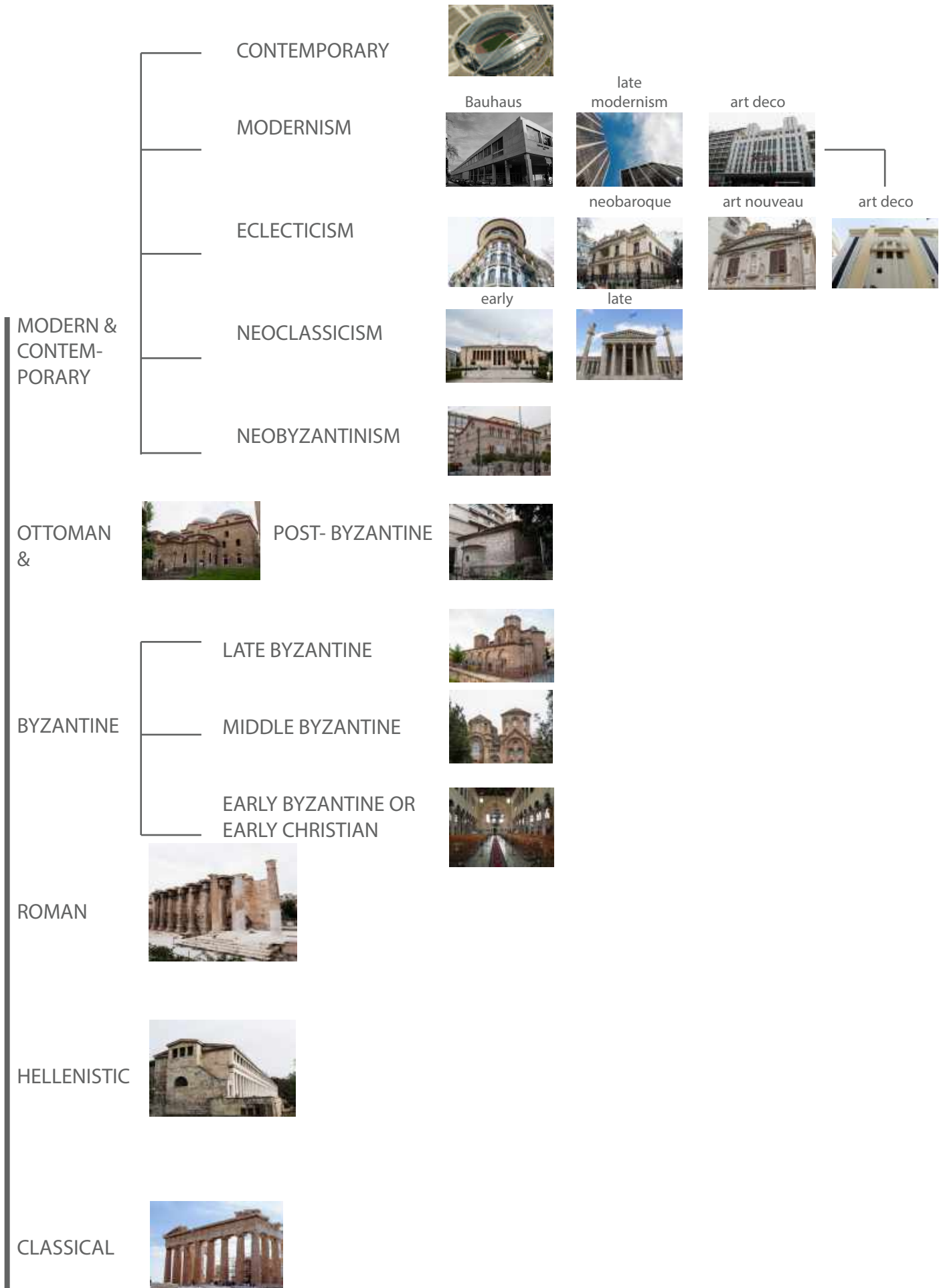



CLASSICAL ARCHITECTURE

Dynamic and synthetic architecture, austerity, human scale, multicolour, construction without synthetic material (dry), columns and architraves, strict grace, density, clarity and freedom of forms, precision and meticulous carving, rational balances, proportional balances : optical axes, angles and escapes, harmony

HELLENISTIC

Heavy decoration, first mosaics, monumental dimensions

ROMAN

Monumental dimensions, arches, plinths, orthomarbbling, Roman concrete, domes

BYZANTINE

Extensive use of brick, domes

EARLY BYZANTINE or EARLY CHRISTIAN

Columns, semicircular arches, basilicas, monumental dimensions, mosaic floors and mosaics on walls and ceilings

MIDDLE BYZANTINE

Smaller scale, cruciform and octagonal churches, domes, hagiographies and mosaics

LATE BYZANTINE

Mixed type churches, luxury, heavy ceramic decoration and mural decoration

POST- BYZANTINE

Secular elements, evolution of Byzantine tradition, basilicas and absence of domes (due to their prohibition by the Ottomans)

OTTOMAN

Stone, wood and brick structure, domes, Islamic art, Byzantine, Persian and Arabic influences, hayats and sahnisia

MODERN AND CONTEMPORARY

Variety of styles, composition

NEOBYZANTINISM

Inspired by Byzantine architecture

NEOCLASSICISM

Inspired by classical architecture

EARLY

Austerity, doricity

LATE

Heavy decoration

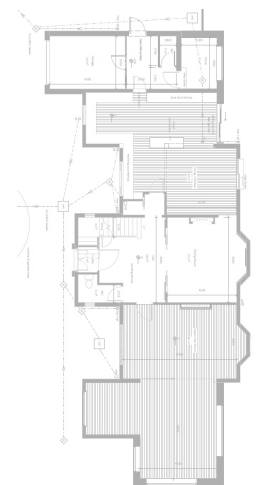

ECLECTICISM

Variety of elements and styles

ART NOUVEAU

Inspired by nature, plants and flowers

NEOBAROQUE

Inspired by the baroque architecture of the 17th and 18th centuries

ART DECO

Experimental architecture, geometrical shapes, modernity

MODERNISM

Functionality, ergonomics, rationalism, straight lines, simple geometry, perspectives, volume alternation, minimalism and highlighting of empty space

BAUHAUS

Simplicity, functionality, geometry, rejection of unnecessary decoration

LATE MODERNISM

Challenging minimalism and the excessive subtraction of modernism

CONTEMPORARY or POSTMODERN ARCHITECTURE

Bioclimatic, harmonization with the environment, local architectural elements (critical localism) but also multinational influences, apotheosis of advanced and high technology, architecture as Performance, star system of architects, pluralistic heterogeneity, experimental architecture as a sculptural work, , a tendency to experimentation

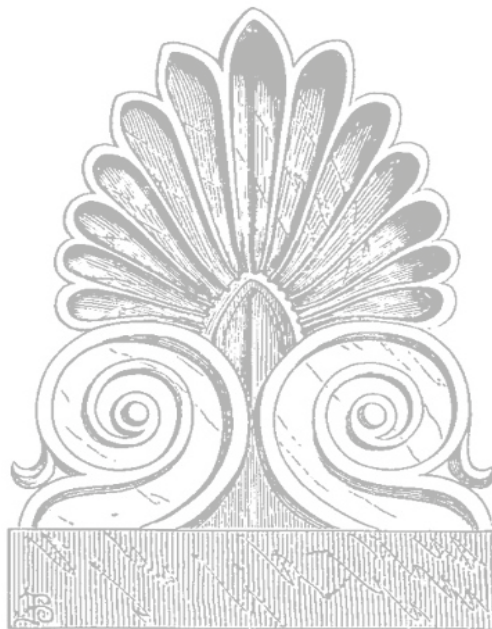

CLASSICAL ARCHITECTURE

HOW CAN I REMEMBER THE DIFFERENT ORDERS?

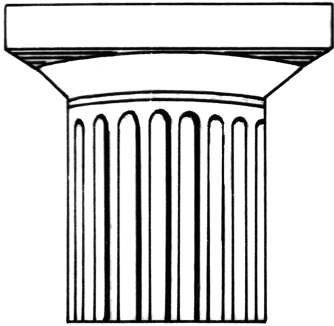

DORIC ORDER



2 SYLLABLES

DO-RIC

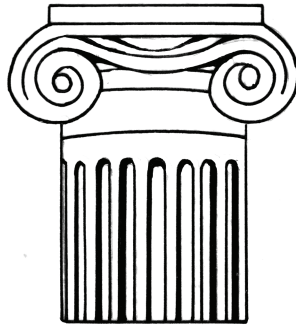

IONIC ORDER



3 SYLLABLES

I-O-NIC

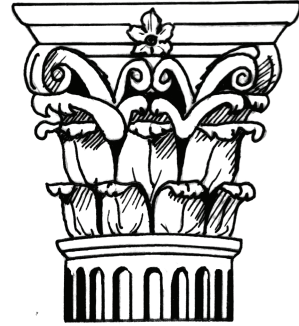

CORINTHIAN ORDER



4 SYLLABLES

CO-RIN-THI-AN

LESS SYLLABLES, SIMPLIER ORDER

MORE SYLLABLES, RICHER ORDER

ANCIENT GREEK TEMPLE (DORIC ORDER)

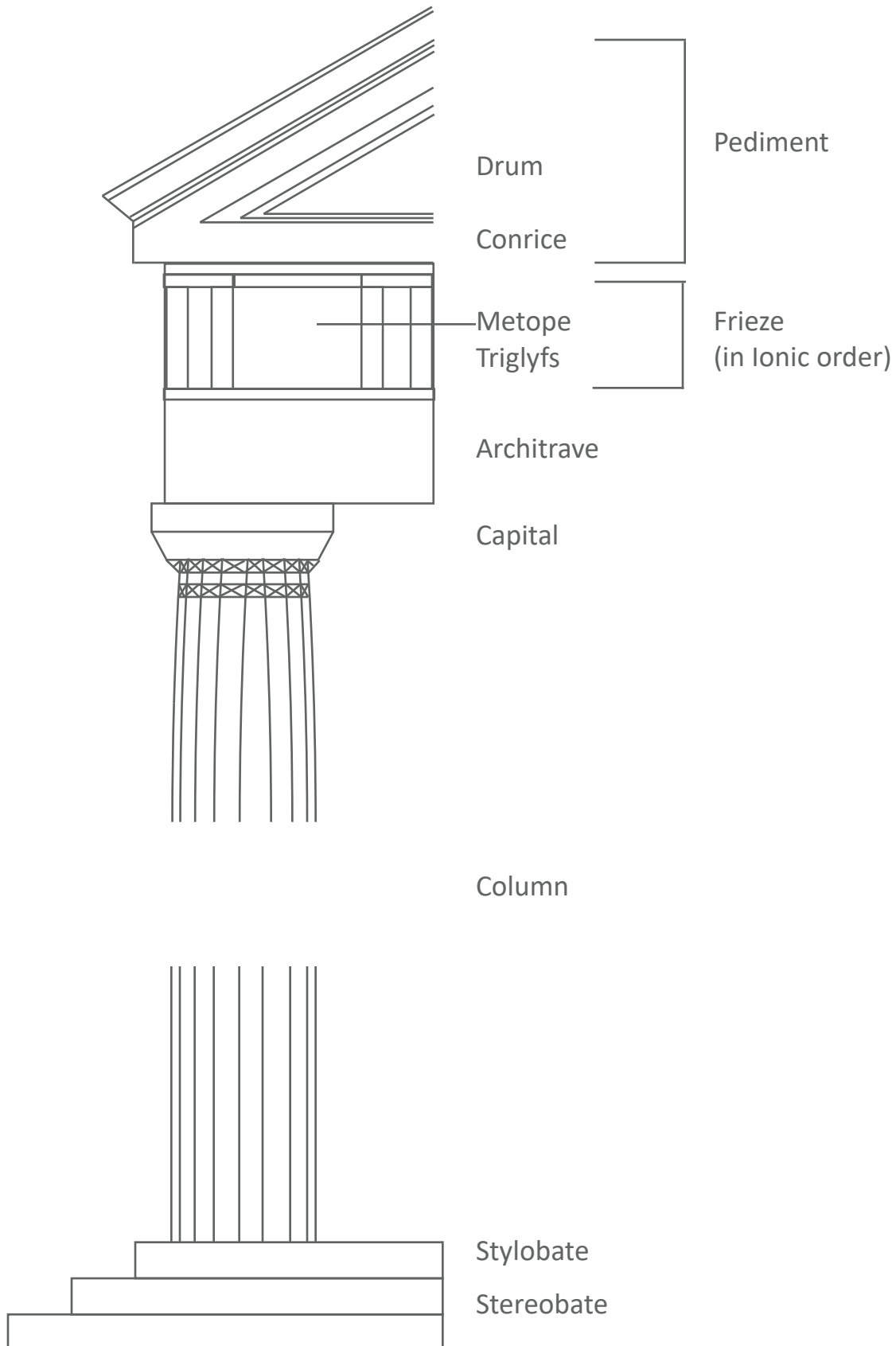

BYZANTINE CHURCHES

SINGLE- AISLED BASILICA



THREE- AISLED BASILICA

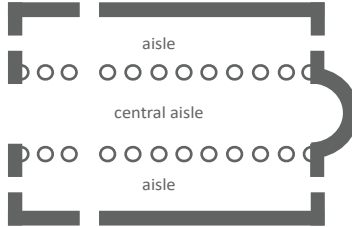

THREE- AISLED BASILICA
WITH NARTHEX

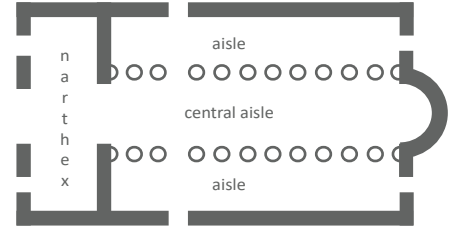

SINGLE- AISLED
BASILICA WITH DOME



THREE- AISLED
BASILICA WITH DOME

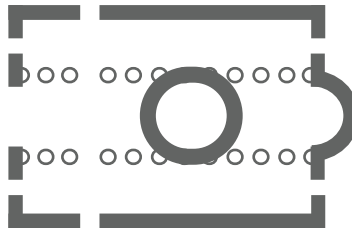

THREE- AISLED BASILICA
WITH DOME AND NARTHEX

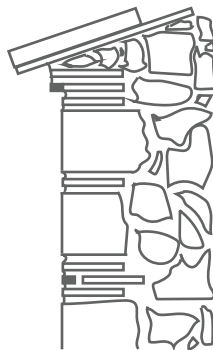
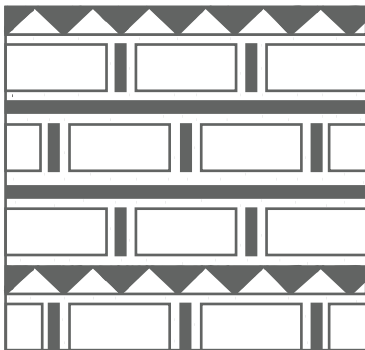
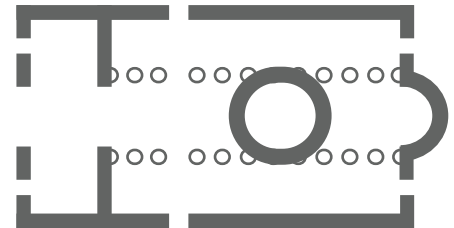

BYZANTINE MASONRY

BRICK- ENCLOSED SYSTEM

(bulky stones with toothed
cornice, inserted thin bricks
and toothed strip)

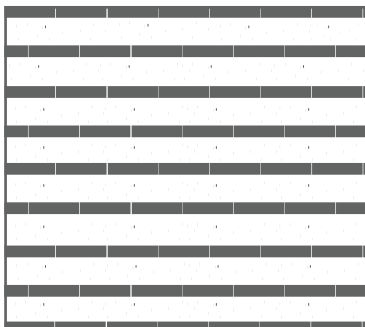

REMOTE ADOBE SYSTEM

(visible surfaces of
horizontal thin bricks)

